

BASIC OPERATION INSTRUCTIONS

SynergyTM TRU-BalanceTM Power Tilt

ACN# 088 609 661

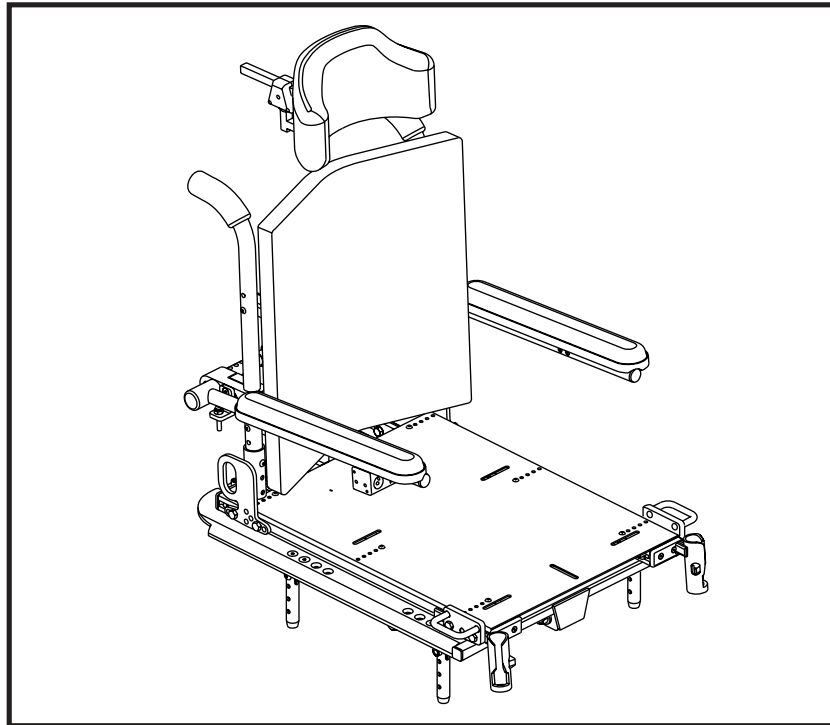

QUANTUM[®]
REHAB

A Division of Pride Mobility Products[®] Corp.

INFORMATION LABELING



WARNING! A Quantum Rehab Specialist or a qualified technician must perform the initial setup of this product and must perform all of the instructions in this manual.

The symbols below are used throughout this owner's manual and on the product to identify warnings and important information. It is very important for you to read them and understand them completely.



WARNING! Indicates a potentially hazardous condition/ situation. Failure to follow designated procedures can cause either personal injury, component damage, or malfunction. On the product, this icon is represented as a black symbol on a yellow triangle with a black border.



MANDATORY! These actions should be performed as specified. Failure to perform mandatory actions can cause personal injury and/or equipment damage. On the product, this icon is represented as a white symbol on a blue dot with a white border.



PROHIBITED! These actions are prohibited. These actions should not be performed at any time or in any circumstances. Performing a prohibited action can cause personal injury and/or equipment damage. On the product, this icon is represented as a black symbol with a red circle and a red slash.

NOTE: These instructions are compiled from the latest specifications and product information available at the time of publication. We reserve the right to make changes as they become necessary. Any changes to our products may cause slight variations between the illustrations and explanations in this manual and the product you have purchased. The latest/current version of this manual is available on our website.

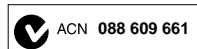

Copyright © 2007
Pride Mobility Products Corporation
INFMANU2285/Rev H/October 07

<h1>TABLE OF CONTENTS</h1>

LABEL INFORMATION 4

INTRODUCTION 5

THE SYNERGY TRU-BALANCE POWER TILT SEATING SYSTEM 7

PRECAUTIONARY GUIDELINES 7

OPERATING THE SYNERGY TRU-BALANCE POWER TILT 10

ARMREST OPTIONS 18

 Flip-Up 18

 Heavy Duty Drop-In 20

 Single Post Quick Height Adjustable Drop-In 22

 Two Post Height Adjustable Flip-Up 25

CONTROLLER POSITION 27

POWER SEAT ELEVATOR OPTION..... 28

MANUAL RECLINE OPTION 29

CARE AND MAINTENANCE 30

WARRANTY 30

LABEL INFORMATION

PRODUCT SAFETY SYMBOLS

The symbols below are used on the seating system to identify warnings, mandatory actions, and prohibited actions. It is very important for you to read and understand them completely.



Read and follow the information in the owner's manual.



Avoid exposure to rain, snow, ice, salt, or standing water whenever possible. Maintain and store in a clean and dry condition.



EMI-RFI - This product has been tested and passed at an immunity level of 20 V/m.



Use correct tie-down points for controller harness to prevent the harness from getting caught in the drive tires, pinched in the seat frame, or damaged when passing through doorways.



Maximum seating weight

INTRODUCTION

WELCOME to Quantum Rehab, a division of Pride Mobility Products Corporation (Pride). The product you have purchased combines state-of-the-art components with **safety**, comfort, and styling in mind. We are confident that the design features will provide you with the conveniences you expect during your daily activities. Understanding how to **safely** operate and care for this product should bring you years of trouble free operations and service.

Read and follow all instructions, warnings, and notes in this manual before attempting to operate your product for the first time. You must also read all instructions, warnings, and notes contained in any supplemental instructional booklets for the controller, front riggings, and/or seating system that accompanied your power chair before initial operation. Your **safety** depends upon you, as well as your provider, caretaker, or healthcare professional in using good judgement.

This manual is to be used in addition to the power base owner's manual that came with your power chair. If there is any information in this manual which you do not understand, or if you require additional assistance for setup or operation, please contact your Quantum Rehab Specialist. **Failure to follow the instructions, warnings, and notes in this manual and those located on your Pride product can result in personal injury and/or product damage and will void Pride's product warranty.**

PURCHASER'S AGREEMENT

By accepting delivery of this product, you promise that you will not change, alter, or modify this product or remove or render inoperable or unsafe any guards, shields, or other safety features of this product; fail, refuse, or neglect to install any retrofit kits from time to time provided by Pride to enhance or preserve the safe use of this product.

INFORMATION EXCHANGE

We want to hear your questions, comments, and suggestions about this manual. We would also like to hear about the safety and reliability of your new Pride product, and about the service you received from your Quantum Rehab Specialist. Please notify us of any change of address, so we can keep you apprised of important information about safety, new products, and new options that can increase your ability to use and enjoy your Pride product.

NOTE: If you ever lose or misplace your product registration card or your copy of this manual, contact us and we will be glad to send you a new one immediately.

My Quantum Rehab Specialist Is:

Name: _____

Address: _____

Phone Number: _____

Purchase Date: _____

THE SYNERGYTRU-BALANCE POWER TILT SEATING SYSTEM

The Synergy TRU-Balance Power Tilt is a unique seating system designed specifically for the Pride Power Chair. It is fully adjustable to meet the individual needs of the user, and it is mounted to a Pride power base to provide maximum maneuverability.

Reusable hook and loop fasteners are included in your owner's package for use in attaching the seat cushion to the seat base. These fasteners are not intended for use on cushions with anti-skid material, as they may damage the seat cushion.

Figure 1 provides information on the Synergy TRU-Balance Power Tilt components. Use this diagram to familiarize yourself with the function and location of each component before using the Synergy TRU-Balance Power Tilt.

PRECAUTIONARY GUIDELINES

Before operating the Synergy TRU-Balance Power Tilt, please read the following. These guidelines are provided for your benefit and will aid you in the safe operation of the seating system.

- Turn off the power before you are seated in the Synergy TRU-Balance.
- Always have assistance when you are being seated in the Synergy TRU-Balance.
- Follow all of the procedures and heed the warnings as explained in your power chair owner's manual.

WARNING! Your Quantum Rehab Specialist configured your Synergy Seating System to suit your specific requirements. Do not change the original configuration without first contacting your Quantum Rehab Specialist.



WARNING! Should the fittings on your Synergy Seating System become loose, report the problem immediately to your Quantum Rehab Specialist.

WARNING! Your Synergy Seating System is not approved for use as a seat in any vehicle. Use the seats and occupant restraints provided by the manufacturer of the vehicle.

WARNING! Do not exceed the weight capacity listed in your power chair owner's manual or 300 lbs. (136 kg; 400 lbs. [181 kg] with the Heavy-Duty option, whichever is less.

Electromagnetic and Radio Frequency Interference (EMI/RFI)



WARNING! Laboratory tests have shown that electromagnetic and radio frequency waves can have an adverse affect on the performance of electrically-powered mobility vehicles.

Electromagnetic and Radio Frequency Interference can come from sources such as cellular phones, mobile two-way radios (such as walkie-talkies), radio stations, TV stations, amateur radio (HAM) transmitters, wireless computer links, microwave signals, paging transmitters, and medium-range mobile transceivers used by emergency vehicles. In some cases, these waves can cause unintended movement or damage to the control system. Every electrically-powered mobility vehicle has an immunity (or resistance) to EMI. The higher the immunity level, the greater the protection against EMI. This product has been tested and has passed at an immunity level of 20 V/m.



WARNING! Be aware that cell phones, two-way radios, laptops, and other types of radio transmitters may cause unintended movement of your electrically-powered mobility vehicle due to EMI. Exercise caution when using any of these items while operating your mobility vehicle and avoid coming into close proximity of radio and TV stations.



WARNING! The addition of accessories or components to the electrically-powered mobility vehicle can increase the susceptibility of the vehicle to EMI. Do not modify your power chair in any way not authorized by Pride.

WARNING! The electrically-powered mobility vehicle itself can disturb the performance of other electrical devices located nearby, such as alarm systems.

NOTE: For further information on EMI/RFI, go to the Resource Center on www.pridemobility.com. If unintended motion or brake release occurs, turn your power chair off as soon as it is safe to do so. Call Pride or contact your Quantum Rehab Specialist to report the incident.

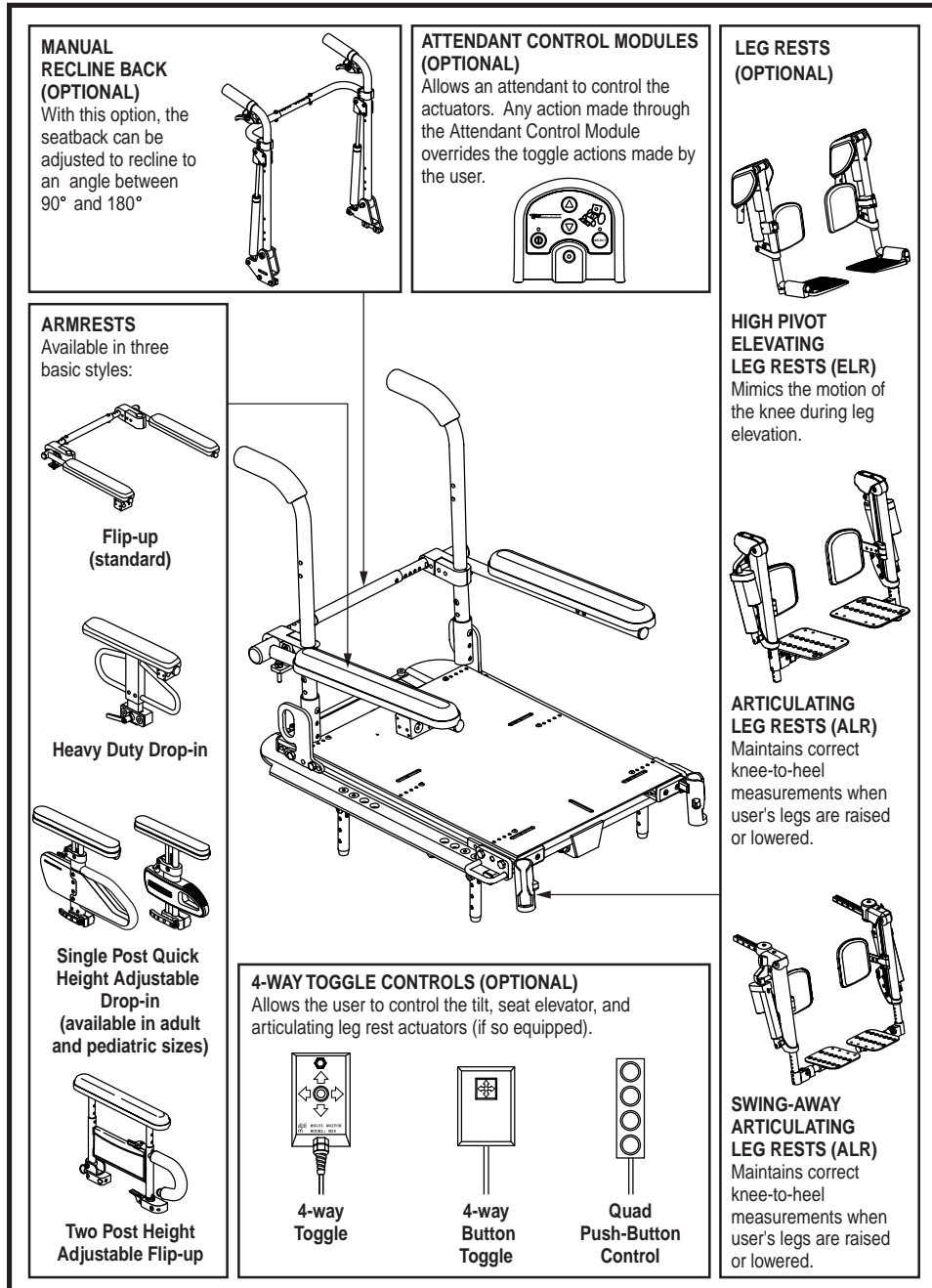

Figure 1. Synergy TRU-Balance Power Tilt and Options

OPERATING THE SYNERGY TRU-BALANCE POWER TILT

The Synergy TRU-Balance Power Tilt can be operated through a PG, Dynamic, or Q-Logic controller, a specialty controller, a single switch, or a toggle (see figures 4 through 11). Your Synergy Seating System provides up to 55° of tilt. See figure 3. There is a power inhibit on your Synergy Seating System which will not allow you to drive your power chair while in the tilt position. A quarter-speed inhibit will activate at 5°-20°, and full inhibit will activate at 20°-55°. See figure 2.

	Recline Lock Out	Tilt Lock Out	Elevate Lock Out	1/4 Speed	Full Drive Lock Out
Elevated	x	x		Active	
Tilted more than 20			x		Active
Reclined more than 20			x		Active
Tilted/reclined more than 170	x	x	x		Active

Figure 2. Inhibit Matrix



WARNING! Check the immediate area before operating the tilt feature. Keep clear prior to and during movement.

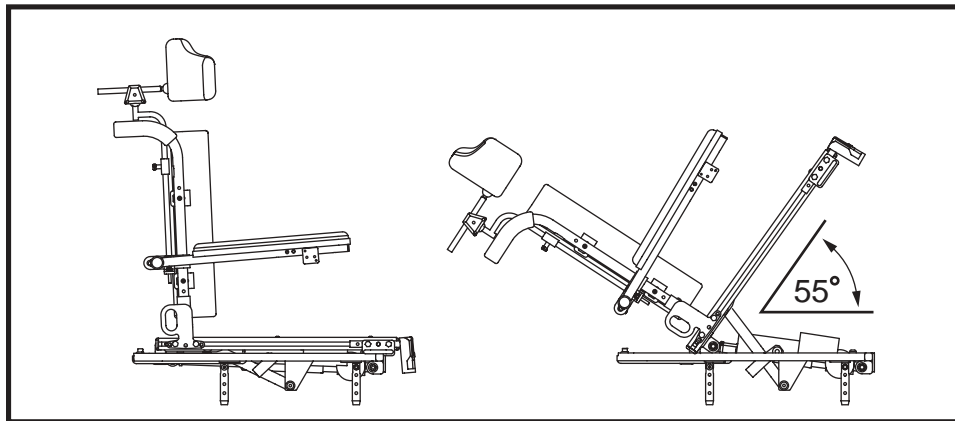

Figure 3. Synergy TRU-Balance Power Tilt Range of Motion

NOTE: Your Synergy TRU-Balance Power Tilt is equipped with safety pressure switches. If any obstruction is detected near the tilt mechanism while you are attempting to tilt or return to a sitting position, the tilt mechanism will automatically stop.

NOTE: This manual will discuss toggle, joystick, and Attendant Control Module operations only. If your Synergy Seating System is equipped with a different operating device, please refer to the operation manual supplied with that device and/or your power chair owner's manual.

Toggle Operation

Your Synergy TRU-Balance Power Tilt may be equipped with a single switch, a 2-way toggle, or one of three available 4-way toggles.

NOTE: Your TRU-Balance Seating System may be equipped with any number of these functions.

Single Switch

1. To tilt backward, push the single switch.
2. To return to a sitting position or to a 0° tilt position, push the single switch again.

2-way Toggle

1. To tilt backward, pull the toggle switch backward.
2. To return to a sitting position or to a 0° tilt position, push the toggle switch forward.

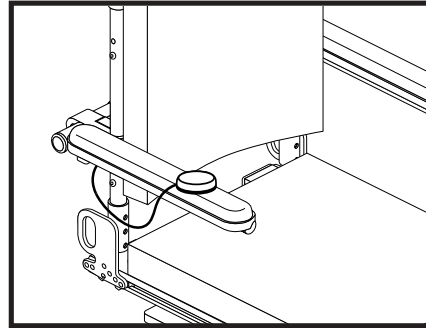

Figure 4. Single Switch Operation

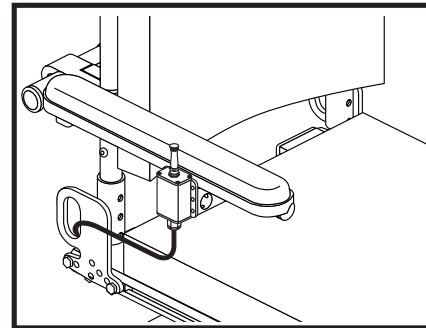

Figure 5. 2-way Multi-Position Toggle Operation

4-way Toggle

■ Tilt Function

1. To tilt backward, pull the toggle switch backward.
2. To return to a sitting position or to a 0° tilt position, pull the toggle switch backward, release, then pull backward again.

■ Seat Elevator Function (Optional)

1. To elevate the seat, push the toggle switch to the left.
2. To lower the seat, push the toggle switch to the left, release, then push to the left again.

■ Combined Leg Rest Function (Optional)

1. To elevate both leg rests, push the toggle switch to the right.
2. To lower both leg rests, push the toggle switch to the right, release, then push to the right again.

■ Independent Leg Rest Function (Optional)

1. To elevate the left leg rest, push the toggle switch to the left.
2. To lower the left leg rest, push the toggle switch to the left, release, then push to the left again.
3. To elevate the right leg rest, push the toggle switch to the right.
4. To lower the right leg rest, push the toggle switch to the right, release, then push to the right again.

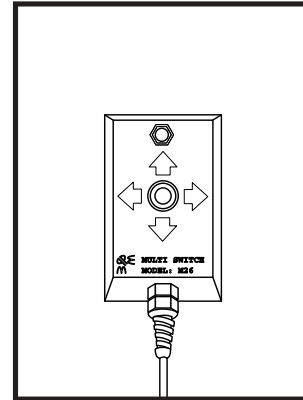

Figure 6. 4-way Toggle Operation

4-way Button Toggle**■ Tilt Function**

1. To tilt backward, pull the toggle button backward.
2. To return to a sitting position or to a 0° tilt position, pull the toggle button backward, release, then pull backward again.

■ Seat Elevator Function (Optional)

1. To elevate the seat, push the toggle button to the left.
2. To lower the seat, push the toggle button to the left, release, then push to the left again.

■ Combined Leg Rest Function (Optional)

1. To elevate both leg rests, push the toggle button to the right.
2. To lower both leg rests, push the toggle button to the right, release, then push to the right again.

■ Independent Leg Rest Function (Optional)

1. To elevate the left leg rest, push the toggle button to the left.
2. To lower the left leg rest, push the toggle button to the left, release, then push to the left again.
3. To elevate the right leg rest, push the toggle button to the right.
4. To lower the right leg rest, push the toggle button to the right, release, then push to the right again.

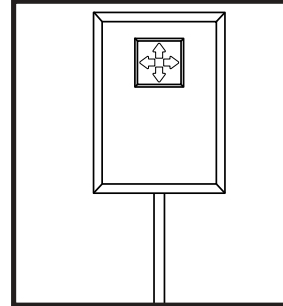

Figure 7. 4-way Button Toggle Operation

Quad Push-Button Control Toggle

■ Tilt Function

1. To tilt backward, push the first button.
2. To return to a sitting position or to a 0° tilt position, push the first button again.

■ Seat Elevator Function (Optional)

1. To elevate the seat, push the third button.
2. To lower the seat, push the third button again.

■ Combined Leg Rest Function (Optional)

1. To elevate both leg rests, push the fourth button.
2. To lower both leg rests, push the fourth button again.

■ Independent Leg Rest Function (Optional)

1. To elevate the left leg rest, push the third button.
2. To lower the left leg rest, push the third button again.
3. To elevate the right leg rest, push the fourth button.
4. To lower the right leg rest, push the fourth button again.

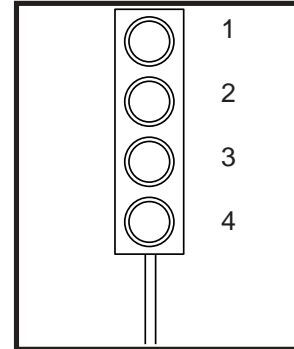

Figure 8. Quad Push-Button Control Toggle Operation

Attendant Control Module

Your SynergyTRU-Balance Power Tilt is equipped with one of two Attendant Control Modules (see figure 9). The actuators can be adjusted either by the user through the controller or the toggle, or by an attendant through the Attendant Control Module. Any action made through the Attendant Control Module will override toggle actions made by the user.

The following actuators can be adjusted using either Attendant Control Module:

- Tilt Function
- Seat Elevator Function (Optional)
- Leg Rest Function (Optional)
- Independent/Combined Leg Rest Function (Optional)

NOTE: *Your TRU-Balance Seating System may be equipped with some or all of these functions.*

If your seating system is equipped with the Attendant Control Module shown in figure 9, the actuators are operated as follows:

1. Press the power key to power on the module.
2. Press Select until the desired actuator is illuminated on the actuator indicator (see figure 10).
3. Use the up and down arrows to operate the actuator to the desired position.

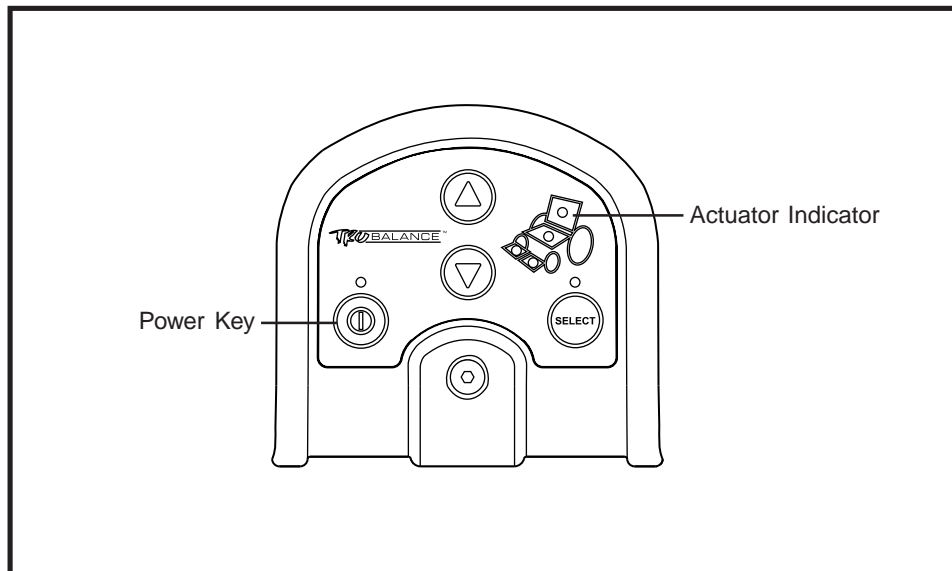

Figure 9. Attendant Control Module

Remote Plus Controller Operation

1. Press the On/Off Key to power on the chair and the controller.
2. Press the Mode Key twice to select actuator adjustment mode.
3. Push the joystick to the right to cycle through the available actuators until the seat back light is illuminated on the actuator indicator. See figure 10.
4. Push the joystick forward to raise the seatback or backward to tilt the seatback.
5. Press the Mode Key again to return to the drive mode.

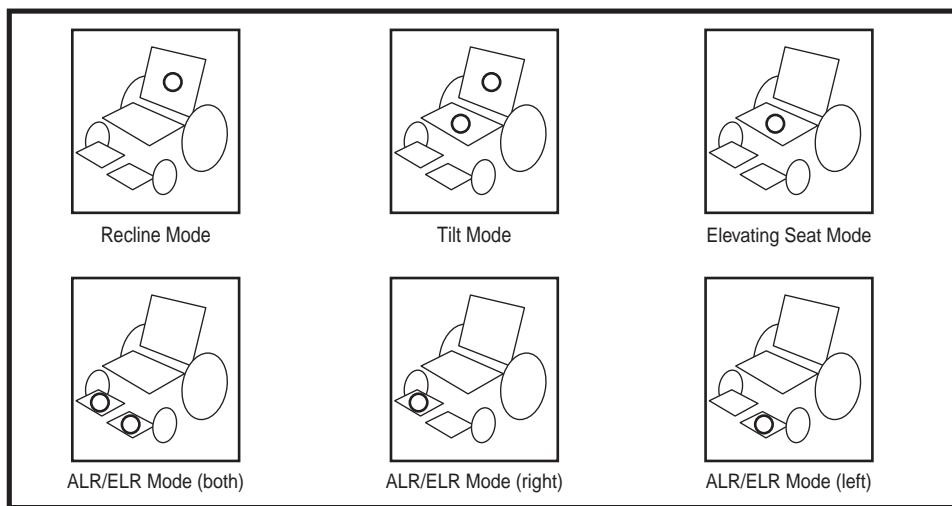

Figure 10. Actuator Modes

Q-Logic Controller Operation

1. Push the On/Off and Mode Select Lever up once to power on the chair and the controller.
2. Push and release the On/Off and Mode Select Lever up once to select actuator adjustment mode.
3. Push the joystick to the right to cycle through the available actuators until the seat and back are illuminated on the actuator indicator. See figure 11.
4. Pull the joystick backward to tilt backward or push the joystick forward to return to a sitting position.
5. Push and release the On/Off and Mode Select Lever until you return to the desired drive profile.

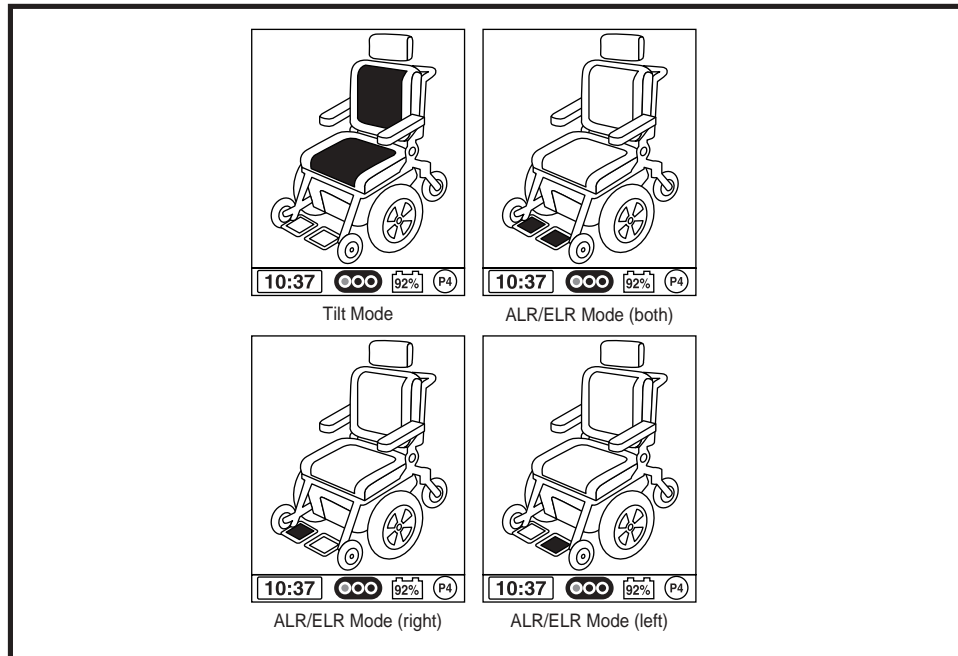

Figure 11. Actuator Modes - Q-Logic

ARMREST OPTIONS

The following sections will describe armrest options and the comfort adjustments that can be made to them.

You may need the following to make comfort adjustments:

- standard hex key set
- standard open-ended wrench set
- Phillips head screwdriver



WARNING! Do not attempt to lift or move your power chair or seating system by any of its removable parts, including the armrests, front riggings, seat cushions, seatback, shrouds, or controller. Use only solid, non-removable frame components to lift or move your power chair or seating system.

WARNING! Prevent personal injury and product damage! Avoid putting all of your weight on the power chair armrests and do not use the armrests for weight bearing purposes, such as transfers. Such use may cause the power chair to tip, resulting in personal injury.

Flip-Up Armrests

The Flip-Up Armrests are attached to the seat canes and are designed to “flip-up” out of the way for easier transfer onto and off of the power chair. Both the armrest angle and the armrest height can be adjusted on the Flip-Up Armrests.

To adjust the armrest angle:

1. Flip the armrests up and out of the way.
2. Loosen the jam nut located on the armrest angle support bracket. See figure 12.

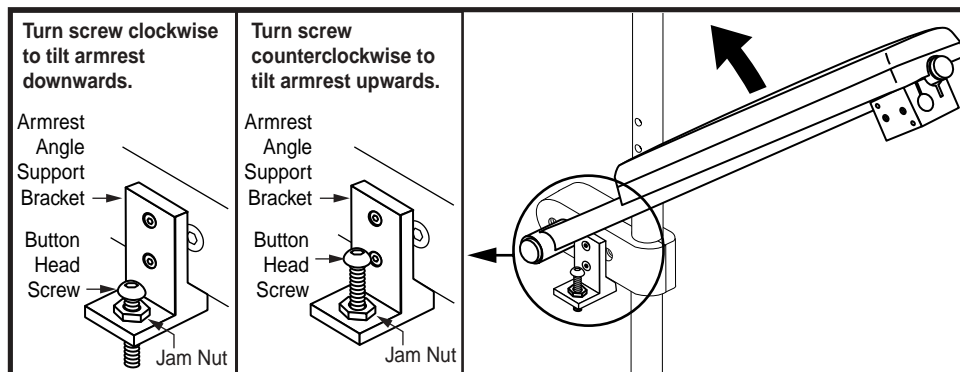

Figure 12. Flip-Up Armrest Angle Adjustment

3. Loosen or tighten the button head screw located on the armrest angle support bracket. Loosening the button head screw will increase the armrest angle; tightening the button head screw will decrease the armrest angle. See figure 13.
4. When the screw has been positioned to the proper angle, tighten the jam nut. See figure 12.
5. Move the armrests down to position.

To adjust the armrest height:

1. Move the armrests up and out of the way.
2. Loosen the jam nut located on the armrest angle support bracket. See figure 13.
3. Remove the button head screw and jam nut from the armrest angle support bracket. See figure 12.
4. Remove the two (2) flat head screws from the armrest angle support bracket, then remove the bracket. See figure 13.
5. Remove the socket head cap screw from the armrest clamp. See figure 13.
6. Raise or lower the armrests to the desired height.
7. Reinstall the socket head cap screw to the armrest clamp. See figure 13.
8. Replace the armrest angle support bracket, then reinstall and tighten the two (2) flat head screws. See figure 13.
9. Reinstall and tighten the button head screw to the armrest angle support bracket, then tighten the jam nut. See figure 12.
10. Move the armrests down to position.

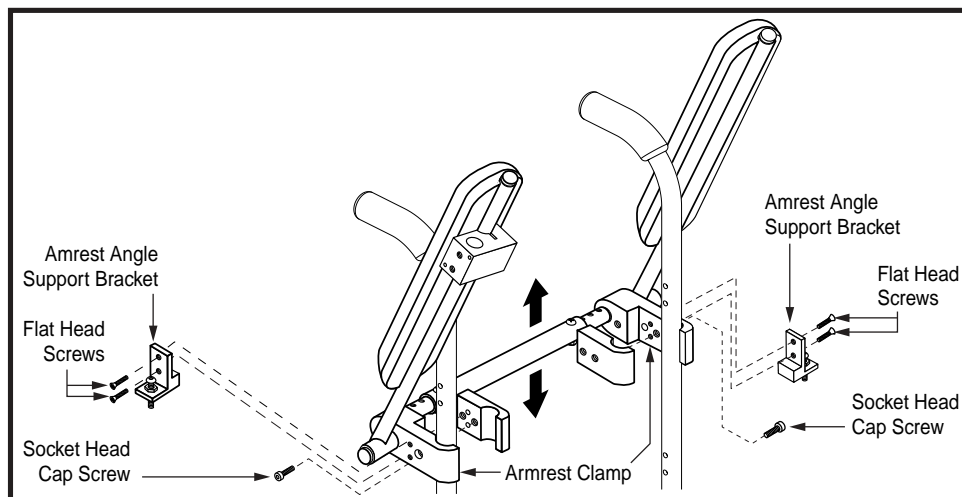

Figure 13. Flip-Up Armrest Height Adjustment

Heavy Duty Drop-In Armrests

The Heavy Duty Drop-In Armrests are attached to the seat with an armrest locking mechanism that is fastened to the side rails of the seating system. These armrests can be removed for easy transfer onto and off of the power chair. The position of the armrest on the chair, as well as the overall height of the armrest, can be adjusted.

To remove the armrest assembly:

1. Rotate the armrest lock lever rearward. See figure 14.
2. Lift up the armrest assembly.

To install the armrest assembly:

1. Place the armrest assembly into the armrest lock. See figure 14.
2. Rotate the armrest lock lever forward.

To adjust the armrest position:

1. Rotate the armrest lock lever rearward and remove the armrest from the armrest lock. See figure 14.
2. Loosen the flat head screws that fasten the armrest lock to the seat base side rail. See figure 15.
3. Slide the armrest lock forward or rearward along the seat base side rail.
4. Tighten the flat head screws.
5. Install the armrest in the armrest lock and rotate the lock lever forward. See figure 15.
6. Repeat for the other side if necessary.

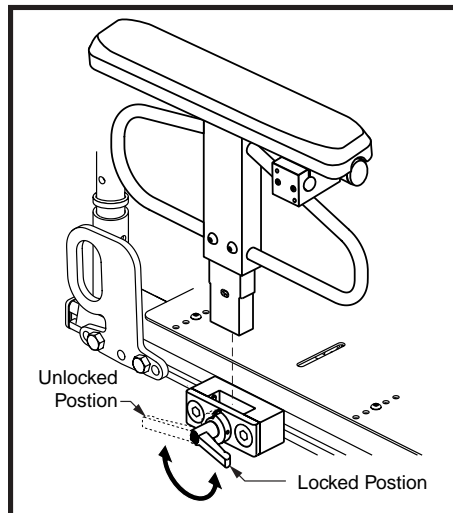

Figure 14. Heavy Duty Drop-In Armrest Removal/Installation

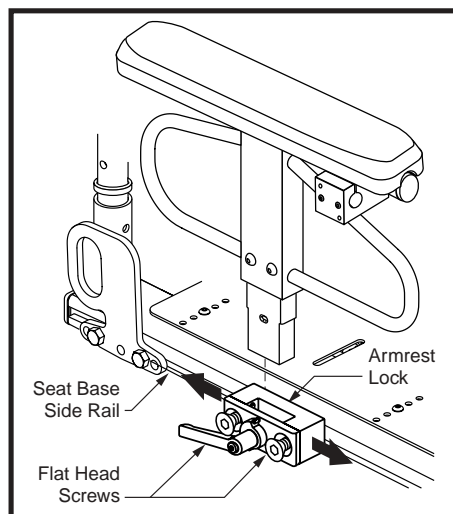

Figure 15. Heavy Duty Drop-In Armrest Position Adjustment

To adjust the armrest height:

1. Rotate the armrest lock lever rearward and remove the armrest from the armrest lock. See figure 16.
2. Remove the two (2) button head cap screws from the side of the armrest.
3. Slide the armrest up or down the detent bar to the desired height.
4. Reinstall the button head cap screws to the side of the armrest.
5. Install the armrest in the armrest lock and rotate the lock lever forward.
6. If necessary, repeat for the other armrest.

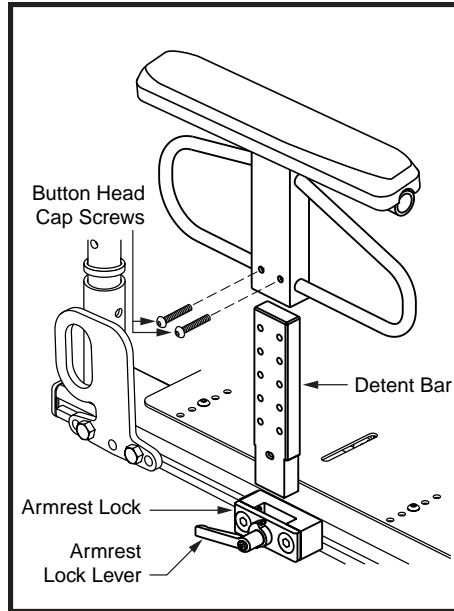

Figure 16. Heavy Duty Drop-In Armrest Height Adjustment

Single Post Quick Height Adjustable Drop-In Armrests

The Single Post Quick Height Adjustable Drop-In Armrests are removable like the Heavy Duty Drop-In Armrests and are available in both adult and pediatric sizes.

To remove the armrest assembly:

1. Rotate the armrest lock lever forward. See figure 17.
2. Lift up the armrest assembly.

To install the armrest assembly:

1. Place the armrest assembly into the armrest lock. See figure 17.
2. Rotate the armrest lock lever rearward.

Adult size armrest height adjustments can be made on both the top and the bottom of the armrest. The total height adjustment range is 6 in. (15.24 cm) from 11–17 in. (27.94–43.18 cm). This range is measured from the seat pan to the top of the armrest pad.

Top height adjustments do not require any tools. The top height adjustment range is 3 in. (7.62 cm) in 3/8-in. (0.95-cm) increments. The bottom height adjustment range is 3 in. (7.62 cm) in 1-in. (2.54-cm) increments.

To adjust the top height:

1. If present, remove the optional locking pin. See figure 18.
2. Pull the armrest up to raise, or press the release lever to lower the armrest to the desired height.
3. If applicable, reinsert the locking pin.
4. Repeat for the other armrest if necessary.

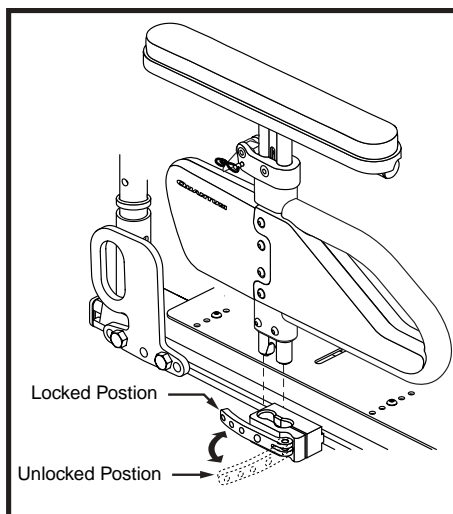

Figure 17. Single Post Quick Height Adjustable Armrest Removal/Installation

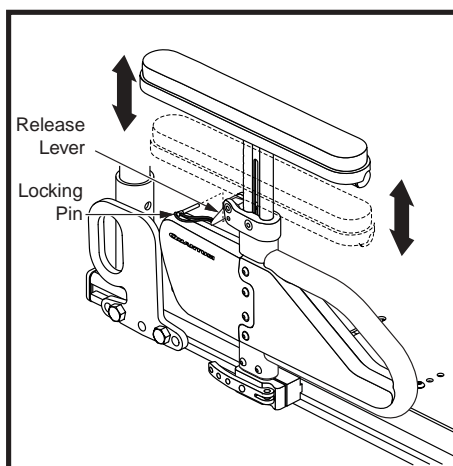

Figure 18. Single Post Quick Height Adjustable Armrest Top Height Adjustment

To adjust the bottom height:

1. Remove the two button head screws from the detent bar. See figure 19.
2. Slide the armrest up or down to the desired height.
3. Line up the holes in the armrest.
4. Reinstall the two button head screws into the detent bar.
5. Repeat for the other armrest if necessary.

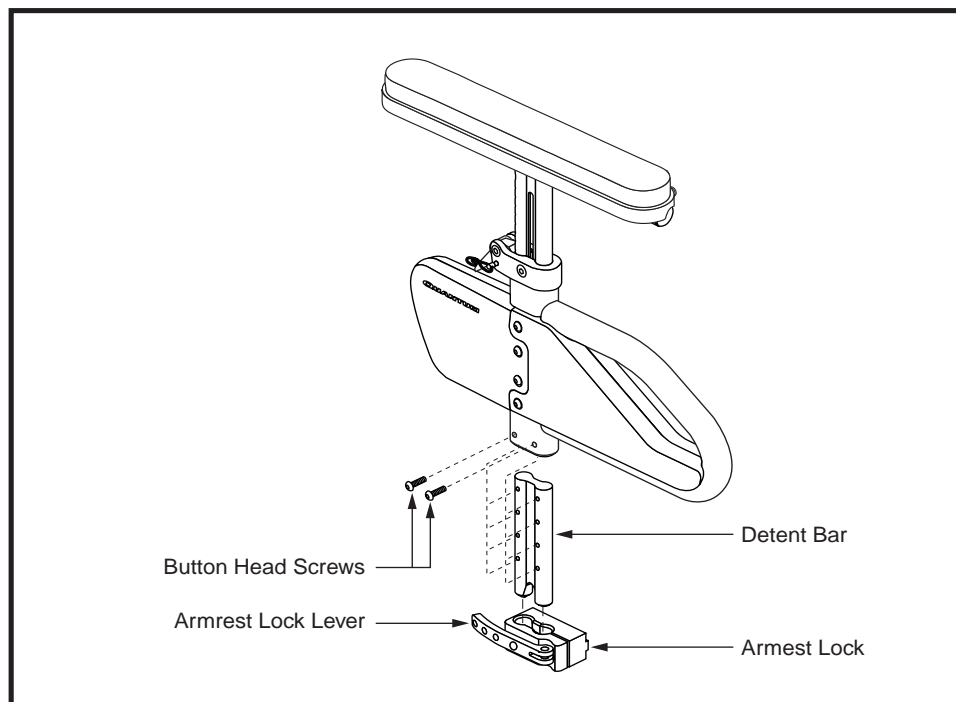

Figure 19. Single Post Quick Height Adjustable Armrest Bottom Height Adjustment

Like the adult size Single Post Quick Height Adjustable Armrest, the pediatric size armrest is designed to be adjusted and removed easily. The total height adjustment range is 3 in. (7.62 cm) in 3/8-in. (0.95-cm) increments. This range is measured from the top of the seat pan to the top of the armrest pad. The total height adjustment range is 7.75–10.75 in. (19.69–27.31 cm).

Top height adjustments do not require any tools. The top height adjustment range is 1 in. (2.54 cm) in 3/8-in. (0.95-cm) increments. The bottom height adjustment range is 2 in. (5.08 cm) in 1-in. (2.54-cm) increments.

To adjust the top height:

1. If present, remove the optional locking pin. See figure 20.
2. Pull the armrest up to raise, or press the release lever to lower the armrest to the desired height.
3. If applicable, reinsert the locking pin.
4. Repeat for the other armrest if necessary.

To adjust the bottom height:

1. Remove the two button head screws from the detent bar. See figure 21.
2. Slide the armrest up or down to the desired height.
3. Line up the holes in the armrest.
4. Reinstall the two button head screws into the detent bar.
5. Repeat for the other armrest if necessary.

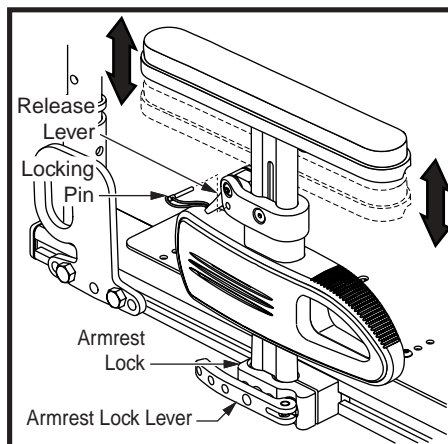

Figure 20. Pediatric Single Post Quick Height Adjustable Armrest Top Height Adjustment

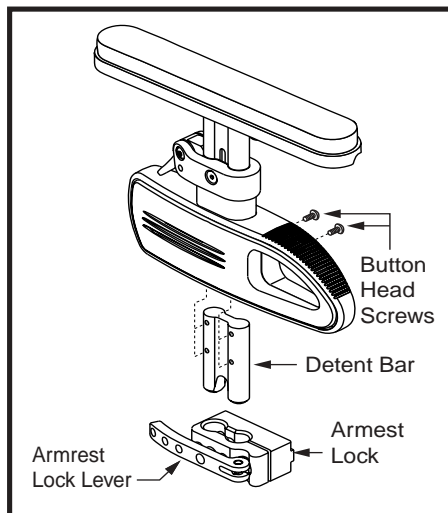

Figure 21. Pediatric Single Post Quick Height Adjustable Armrest Bottom Height Adjustment

Two Post Height Adjustable Flip-Up Armrests

The height adjustment range for the Two Post Height Adjustable Flip-Up Armrest is 4 in. (10.16 cm) in 1-in. (2.54-cm) increments. The total height adjustment range is 10-14 in. (25.4–35.56 cm). This range is measured from the top of the seat rail to the top of the arm pad. You can also flip the armrests up or remove them for transfer. See figure 22.

To remove the armrest assembly:

1. Push the spring-loaded lever downward and pull up on the front of the armrest. See figure 22.
2. Remove the detent pin from the back of the seat. See figure 22.
3. Pull up on the rear of the armrest to remove the assembly.

To install the armrest assembly:

1. Set the rear of the armrest into the rear seat receiver and install the detent pin. See figure 22.
2. Rotate the armrest assembly down.
3. Push the front of the armrest into the front seat receiver and rotate the spring-loaded lever to the horizontal position to lock into place.

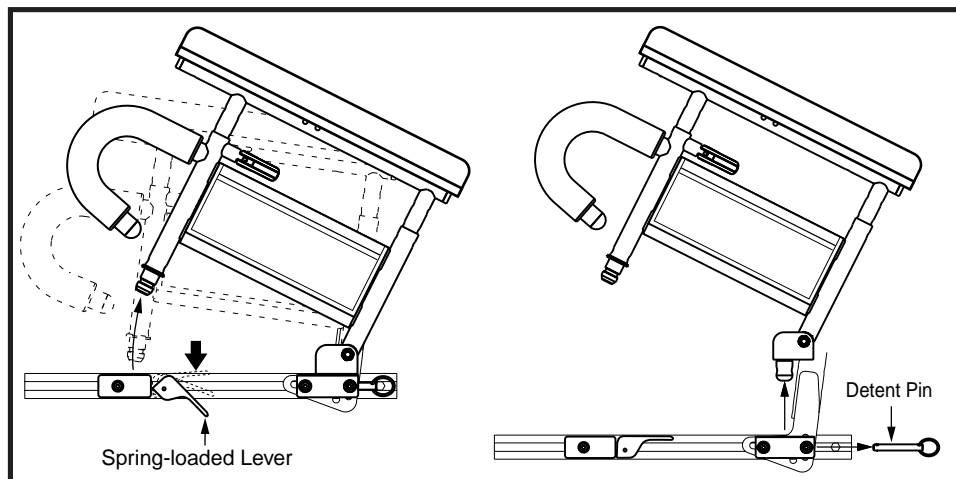

Figure 22. Two Post Height Adjustable Flip-Up Armrest Removal and Installation

To adjust the armrest height:

1. Push the spring-loaded lever inward. See figure 23.
2. Move the armrest up or down to the desired height.
3. Rotate the spring-loaded lever outward and lock the armrest in place. If necessary, move the armrest up or down to ensure that the armrest is secure.

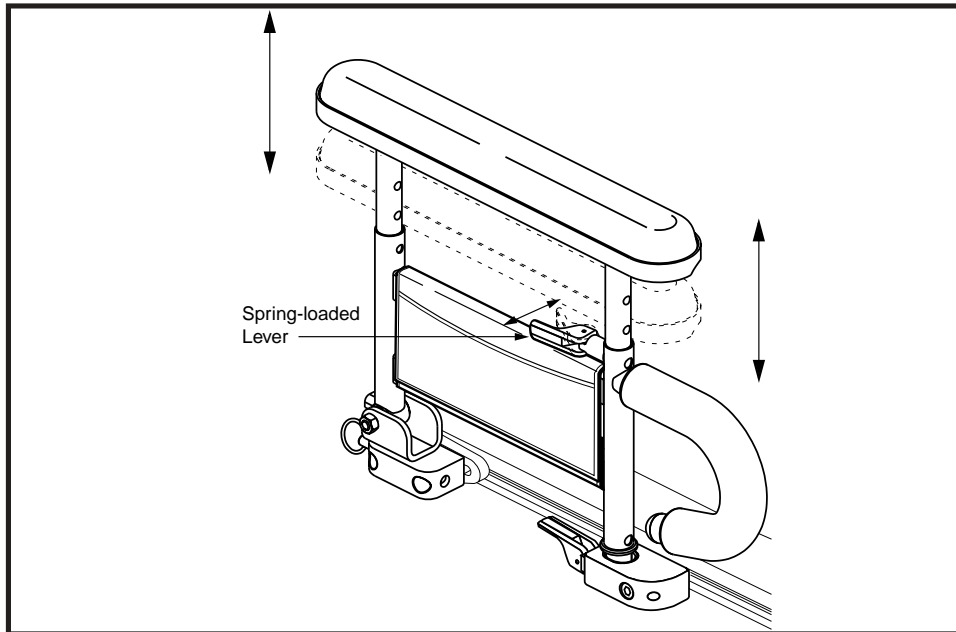

Figure 23. Two Post Height Adjustable Flip-Up Armrest Height Adjustment

CONTROLLER POSITION

You can position the controller for either left-hand or right-hand use. You can also adjust the extension of the controller from the armrest.



MANDATORY! Prevent controller harness damage! Avoid routing the controller harness on the outside of the armrest pad. Route the harness under the armrest or toward the inside of the armrest pad. Use correct tie-down points for the controller harness to prevent the harness from getting caught in the drive tires, pinched in the seat frame, or damaged when passing through doorways.

To change the controller position:

1. Turn off the power to the controller.
2. Unplug the controller connector from the power base. Refer to power base owner's manual.
3. Remove any wire ties securing the controller cable to the armrest.
4. Loosen the mounting screws in the controller mounting block. See figure 24.
5. Move the controller mounting block and controller to the other armrest and tighten the mounting screws.
6. Route the controller cable to the back of the power base and reconnect the controller. See figure 25.

To change the controller extension:

1. Turn off the power to the controller.
2. Loosen the setscrews in the controller mounting block. See figure 24.
3. Slide the controller into or out of the mounting block to the desired position.
4. Tighten the setscrews to secure the controller.

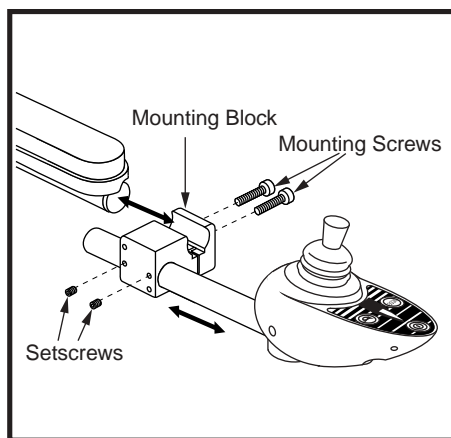

Figure 24. Controller Position - Mounting Block

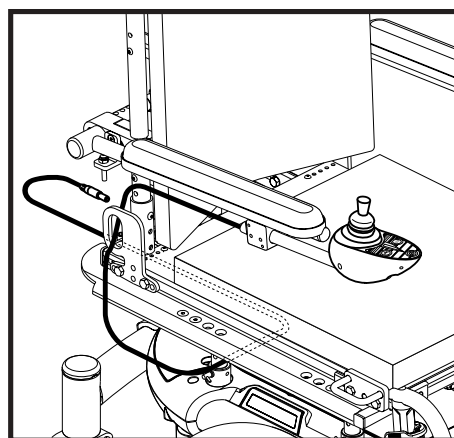

Figure 25. Cable Routing

POWER SEAT ELEVATOR OPTION

The power seat elevator provides lift of up to 7 in. (18 cm) from the power base using a single post plate and actuator. See figure 26. The maximum weight capacity of the power seat elevator is 300 lbs. (136 kg) and is available on some models. Contact your Quantum Rehab Specialist for specific information. The power seat elevator operates through the power chair controller or toggle switch.

NOTE: *When the seat is elevated, a quarter-speed drive inhibit is engaged and you are no longer able to tilt the seat.*

To operate the power seat elevator:

1. Pull the toggle switch backward to elevate the seat.
2. Push the toggle switch forward to lower the seat.

NOTE: *Operation instructions using the joystick 4-way toggles are discussed below. If you are using a different toggle, the Attendant Control Module, or a different operating device, please refer to the appropriate section of this manual or the operation manual supplied with that device and/or your power chair owner's manual.*

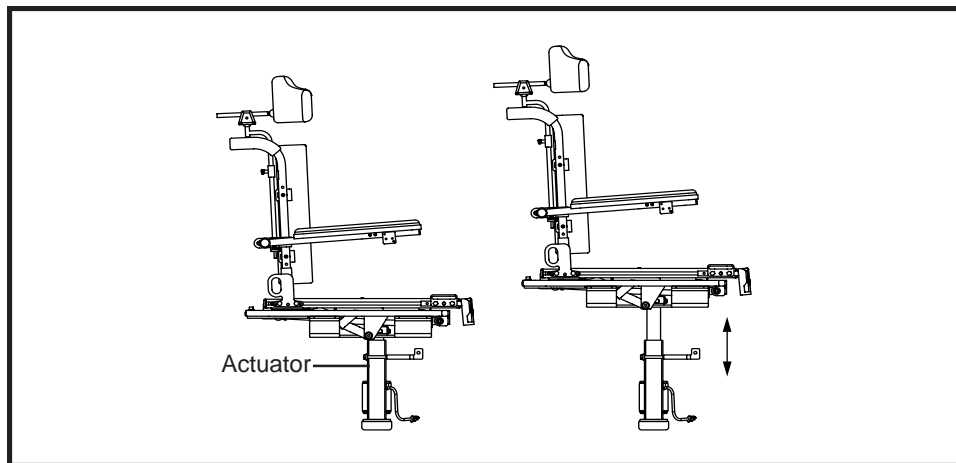

Figure 26. The Power Seat Elevator Option

MANUAL RECLINE OPTION

If your Synergy TRU-Balance Power Tilt includes Pride's Manual Recline Option, you can adjust the seatback to angles ranging from the minimum recline position (90° from the seat base) to the maximum recline position (180° from the seat base). See figure 27. When the seat is reclined past 110°, an inhibit switch will cut power to the motors of your power chair. Returning the seat to an angle of less than 110° degrees will restore power to the motors.

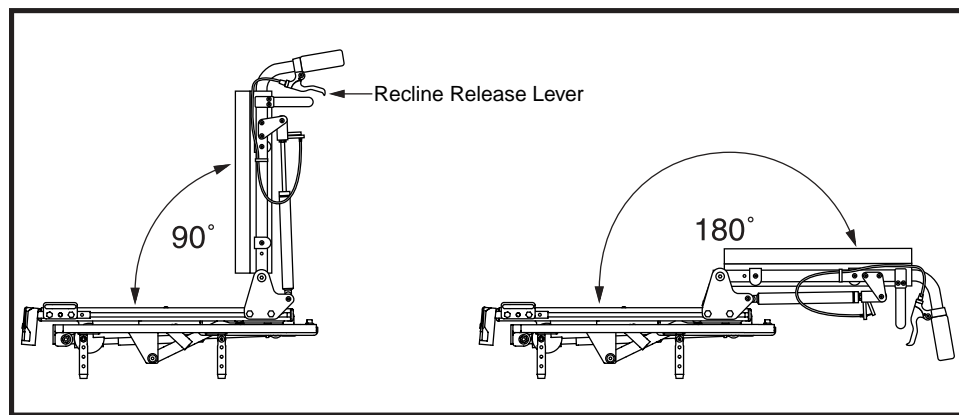

Figure 27. Minimum and Maximum Recline Angles



WARNING! Never recline the seatback while the chair is tilted. A safety feature will not allow you to tilt the seat while it is reclined past 110°. To reactivate the tilt feature, return the reclining seatback to an upright position.

To recline the seatback:

1. Grasp the handles at the top of the seatback.
2. Squeeze both of the recline release handles simultaneously, and position the seatback to the desired angle. See figure 28.
3. Release the handles to lock the seatback into position.

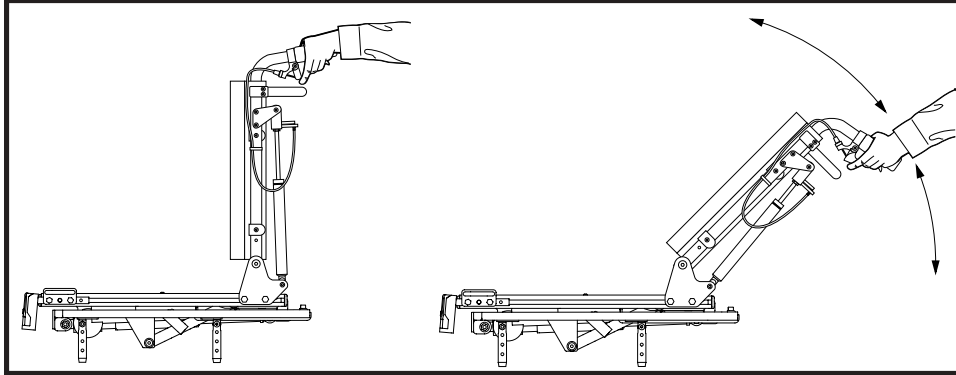

Figure 28. Manual Recline Angle Adjustment

CARE AND MAINTENANCE

- Make sure all hardware is secured properly, but do not overtighten any hardware.
- To clean the seating system, wipe it with a cloth dampened with mild soap and water. Thoroughly dry the unit before using.



PROHIBITED! Avoid exposure to rain, snow, ice, salt, or standing water whenever possible. Maintain and store in a clean and dry condition.



WARNING! Pride strongly recommends that you do not smoke cigarettes while seated in your seating system although the seating system has passed the necessary testing requirements for cigarette smoking. You must adhere to the following safety guidelines if you decide to smoke cigarettes while seated in your seating system.

- Do not leave lit cigarettes unattended.
- Keep ashtrays a safe distance from the seating system.
- Always make sure cigarettes are completely extinguished before disposal.

WARRANTY

Three-Year Limited Warranty

For three (3) years from the date of purchase, Pride will repair or replace at our option to the original purchaser, free of charge, any of the following parts found upon examination by an authorized representative of Pride to be defective in material and/or workmanship:

- Structural frame components

Two-Year Limited Warranty

For two (2) years from the date of purchase, Pride will repair or replace at our option to the original purchaser, free of charge, any of the following parts found upon examination by an authorized representative of Pride to be defective in material and/or workmanship:

- Electronics

Eighteen-Month Warranty

For eighteen (18) months from the date of purchase, Pride will repair or replace at our option to the original purchaser, free of charge, any of the following parts found upon examination by an authorized representative of Pride to be defective in material and/or workmanship:

- Actuator

Warranty service can be performed by a Quantum Rehab Specialist or by Pride. Do not return faulty parts to Pride without prior consent. All transportation costs and shipping damage incurred while submitting parts for repair or replacement are the responsibility of the original purchaser.

Warranty Exclusions

- Upholstery and seating
- Repairs and/or modifications made to any part without specific consent from Pride
- Circumstances beyond the control of Pride
- Labor, service calls, shipping, and other charges incurred for repair of the product, unless specifically authorized by Pride.

- Damage caused by:
 - Battery fluid spillage or leakage
 - Abuse, misuse, accident, or negligence
 - Improper operation, maintenance, or storage
 - Commercial use or use other than normal

There is no other express warranty.

Implied warranties, including those of merchantability and fitness for a particular purpose, are limited to one (1) year from the date of purchase and to the extent permitted by law. Any and all implied warranties are excluded. This is the exclusive remedy. Liabilities for consequential damages under any and all warranties are excluded.

Some states do not allow limitations on how long an implied warranty lasts or do not allow the exclusion of limitation of incidental or consequential damages, so the above limitation or exclusion may not apply to you.

This warranty gives you specific rights, and you may also have other rights which vary from state to state.

Please fill out and return the product registration card to Pride Mobility Products Corporation. This will aid Pride in providing the best possible technical and customer service.

NOTES

NOTES

NOTES

QUANTUM[®] **REHAB**

A Division of Pride Mobility Products[®] Corp.

Pride Mobility Products Corporation

182 Susquehanna Avenue
Exeter, PA 18643-2694
USA

Pride Mobility Products Company

380 Vansickle Road Unit 350
St. Catharines, Ontario L2R 6P7
Canada

Pride Mobility Products Ltd.

Unit 106, Heyford Park Camp Road
Upper Heyford, Oxfordshire OX25 5HA

Pride Mobility Products Australia Pty. Ltd.

21 Healey Road
Dandenong, 3175
Victoria, Australia

Pride Mobility Products Italia S.r.l.

Via del Progresso - ang. Via del Lavoro
Loc. Prato della Corte
00065-Fiano Romano (RM)

Pride Mobility Products Europe B.V.

Tijnmuiden 28
1046 AL Amsterdam
The Netherlands

Pride
Mobility Products Corp.

www.pridemobility.com www.prideservice.com www.quantumrehab.com

* I NFMANU2285 *